



Manufacturer: -
BARTON FIRTOP ENGINEERING COMPANY LIMITED
 Silverwoods Way,
 Kidderminster. Worcestershire. DY11 7DT.
 UNITED KINGDOM
 Telephone: +44 (0)1527 831644
 Fax: +44 (0)1527 832638
 E-mail: sales@bartonfirtop.co.uk

Data Sheet Number:
SDD/YSW/1975/CS
 Revision: **08**

SOCKETWELD - 1975 PSI – CARBON STEEL - 'Y'-TYPE STRAINER

Sizes: ½" to 2" NB

Pressure: 1975 psi Rating (136.20 Barg)

Features:

- Investment Cast Housing
- Screwed Cover c/w Drain Plug
- Ø3.0 Perf. Screen as Standard
- Full ASME B16.34 800 rating
- 1.6mm Corrosion Allowance
- Red Oxide Finish

Options:

- Meshed Screen to Customer Spec.
- Special Gasket
- Special Screen
- Special Finish/Painting

Standards:

- PED 2014/68/EU
- ASME B16.11 Dimensions
- EN 10204 / NACE Certification
- Generally i.a.w. ASME VIII, Div. 1

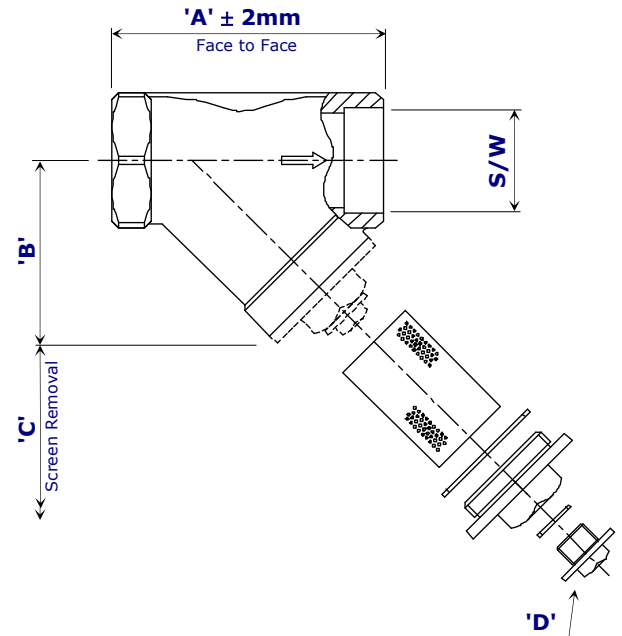

All data is subject to confirmation at the time of order.
 Our policy is one of continual improvement and we reserve the right to amend details without prior notice.

Size		Dimensions (mm)				Screen	Weight (kg)
		'A' Face to Face	'B' Base to Centre line	'C' Screen Removal	'D' Drain (BSPP)		
Inch	mm						
½"	15	70.0	50.0	70.0	¼" BSPP	0.5	
¾"	20	86.0	60.0	85.0	¼" BSPP	0.8	
1"	25	102.0	72.0	95.0	½" BSPP	1.3	
1¼"	32	132.0	90.0	130.0	½" BSPP	2.5	
1½"	40	132.0	90.0	130.0	½" BSPP	2.5	
2"	50	150.0	105.0	170.0	½" BSPP	3.8	

Materials of Construction	
Item	Carbon Steel
Strainer Body (Cast)	ASME SA216 WCB
Strainer Cover (Cast)	ASME SA216 WCB
Cover Gasket	P.T.F.E. as Standard
Drain Plug (Cast)	ASME SA216 WCB
Drain Gasket	P.T.F.E. as Standard
Screen (Perforated)	St.St.316 (Ø3.0mm as Standard / to Customer Specification)

Model Number Derivation: -

The model number can be derived as follows: - **YSW/BFI/***/216**

Denotes the size e.g. add '025' for a 1" _____

For more information, visit our Web Site: www.bartonfirtop.co.uk